

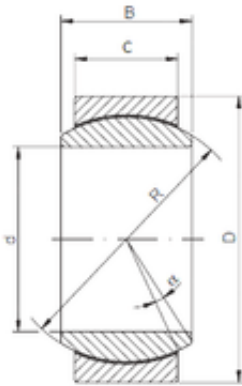

# KOYO PRECISION AXLE CORP.

25 mm x 42 mm x 20 mm ISO GE 025 ECR-2RS  
plain bearings



Bearing No. GE 025 ECR-2RS

Size	25x42x20 mm
Bore Diameter	25 mm
Outer Diameter	42 mm
Width	20 mm
d	25 mm
D	42 mm
B	20 mm
C	16 mm
R	35,5 mm
Angle	7 °

GE 025 ECR-2RS Bearing 2D drawings and 3D CAD models